

# SHOP DRAWING - WAREHOUSE ENTRANCE DOOR GLACE-GUARD ET-400

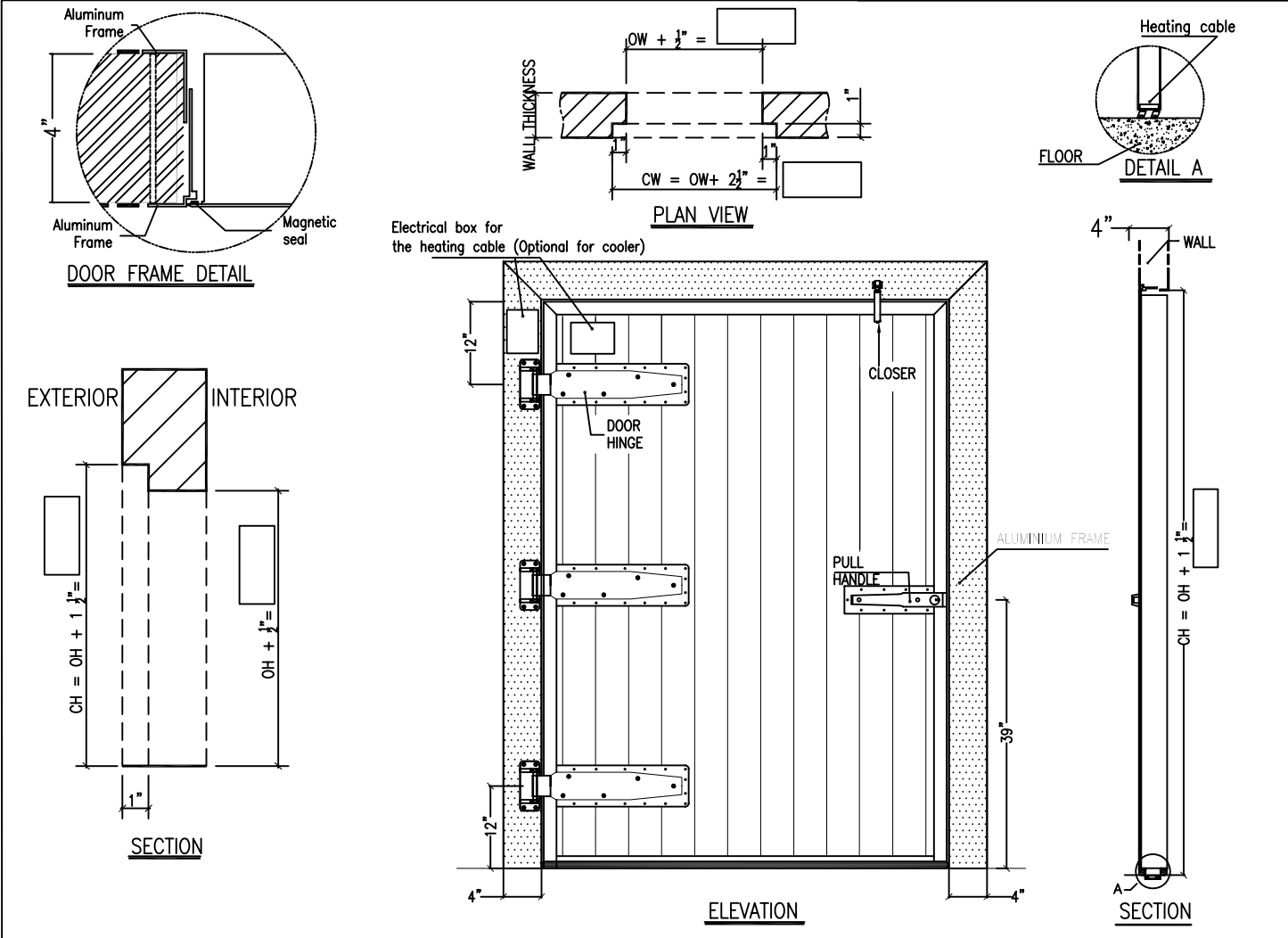

- Specifications:**
- ☐ ET-400: 4" (100mm)
  - ☐ Cooler 2° C @ 5° C (35° F @ 40° F)
  - ☐ Freezer -29° C @ 0° C (-20° F @ 32° F)
  - ☐ Heating cable on four (4) sides
  - ☐ Left side hinges viewed from the outside

- Standard Features:**
- \*Polyurethane insulated panels
  - \*26ga steel, white stucco embossed finish
  - \*Heavy-duty  $\frac{5}{32}"$  (4mm) aluminium opening frame in two extruded angles
  - \*Magnetic seals on door frame perimeter.
  - \*Bottom double blade seal on door panel.
  - \* 3 (three) 21" cam-lift hinges.
  - \* 1 (one) pull handle.
  - \* 1 (one) mechanical closer.

- Options:**
- ☐ Panic Bar
  - ☐ Window: triple thermo glass clear 12"x24"x  $\frac{1}{8}"$
  - ☐ Kick plate made of  $\frac{1}{8}"$  aluminium checker plate x 24" high x one side

DIMENSIONS	QTY	FINISHED OPENING		REQUIRED CLEARANCE		APPROVED FOR MANUFACTURING BY:	
		WIDTH (OW)	HEIGHT (OH)	WIDTH (CW)	HEIGHT (CH)	Name:	Date:
						Signature:	

GLACE-GUARD Cold Storage Doors

THERMOSTOP INC.

3775, boulevard Losch, Longueuil (Québec), Canada J3Y 5T7,  
Tel.: (450) 678-8666, Fax: (450) 678-7765, www.thermostop.com

Distributor:	Date:	Drawn by:	Verify by:	Page:	Note : *Drawings not to scale
Customer:	Revision:		L.H.	1/1	

**Legend**

OW = OPENING WIDTH  
OH = OPENING HEIGHT  
CW = CLEARANCE WIDTH  
CH = CLEARANCE HEIGHT